

KENWOOD VALVE CONTROLS (INDIA) PRIVATE LIMITED

5/2-way, 3/2-way(Convertible)NAMUR Mounting Solenoid valve(Series-523214)

SPECIFICATION :

Sizes	: 6mm(1/4")
End Connections	: Standard-BSP
Construction-Body	: Aluminium deep anodized bar stock
Construction-Seat	: Nitrile
Operating Pressure	: 1.5 to 8bar
Temperature of fluid	: -5°C to 50°C
Coil Voltage	: Standard-24VDC. Optional-220VAC/110VAC, 50Hz.
Coil insulation and Temperature	: Class 'F' insulated upto 155°C
Coil rating	: Continuously rated
Enclosure	: SQ moulded coil IP-65
Fluids	: Lubricated and non-lubricated air/gas filtered to 50 microns.
Minimum flow factor(Kv)	: 1.1 for Double acting 0.6 for Single acting

Ordering/Part code:

5232141--- With 220VAC
5232142--- With 24VDC
5232143--- With 110VAC
5232144--- With 110VDC

Standard features:

Reliable fast acting valve for multimillion operations. Lockable resettable manual override as a standard. Valve type 3/2-way(for single acting) or 5/2-way(for double acting) is selectable by using the orientation of plastic disc in No.4 port. coils are supplied with DIN connector and with LED as a standard.



Application:

When using as a 5/2-way valve, one can operate double acting actuator. When using as a 3/2-way valve, one can operate on single acting, spring return actuator. While exhausting, portion of air is reintroduced in spring chamber, Mostly used in process industry, specially on single acting and double acting 90° turn actuator.

DIMENSIONS

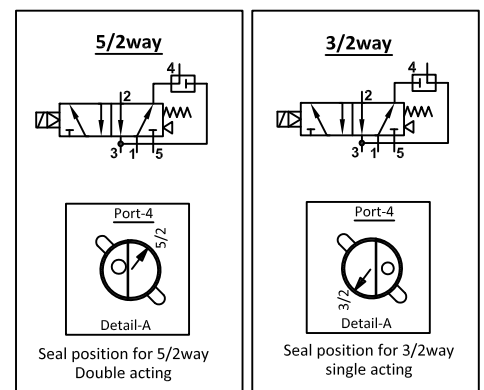
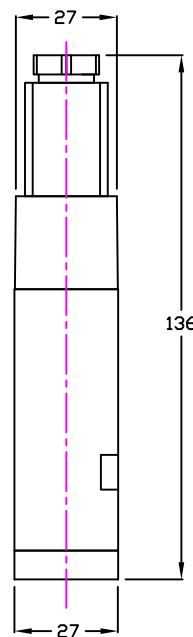
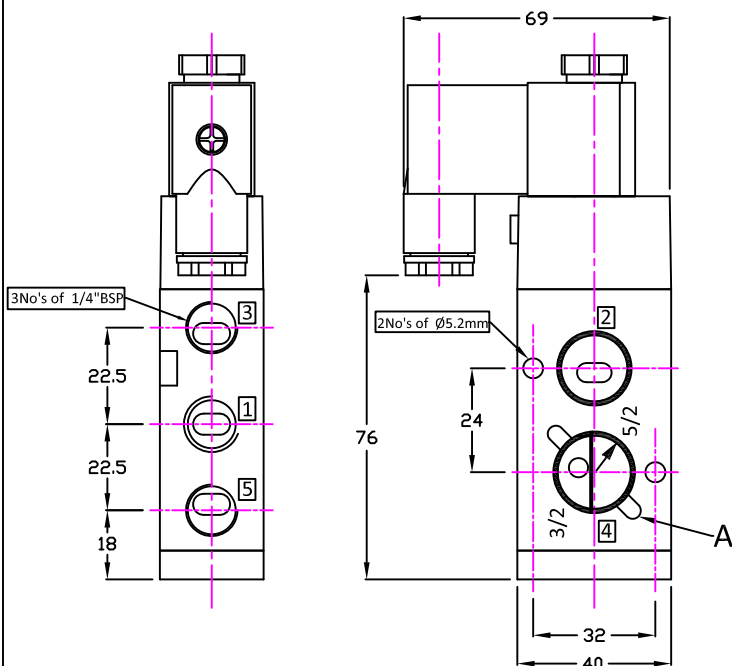

NOTE:

Port-1: Inlet
 Port-2: Outlet (Connect this to air chamber
 incase of single acting or spring return)
 Port-4: Outlet
 Port-3&5: Exhaust